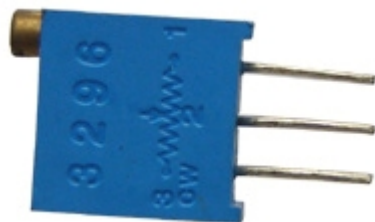
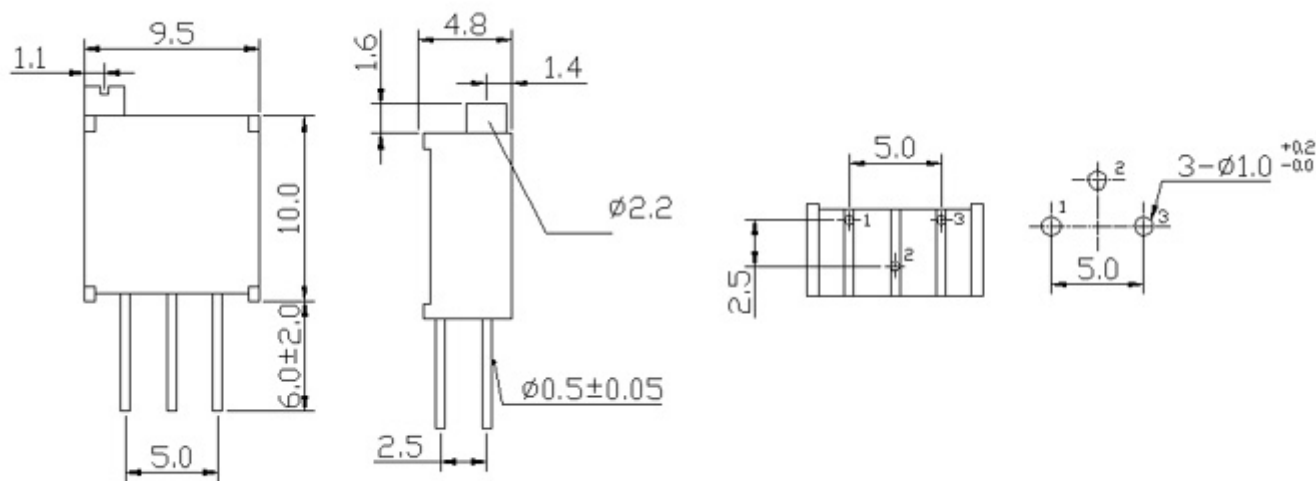

**Model(型號): ROTARY POTENTIOMETER-----WR3296Y**
[Download PDF file](#)

**Features:(特點):**

Measuring equipment, cMany models are available.High performance and high dependability.  
 Automatic adjustment (with automatically adjustable driver)possible.  
 Being of sealed structure,the potentiometers may be cleane with a variety of cleanign liquids.  
 Easy adjustment by large diameter shaft.  
 The adjustable screwdriver available i the commercial market can be used.

**Applications(作用):**

Measuring equipment,communication device,industrial machines,high requirements for environmet.

**Dimensions(規格圖 ):**

**Specifications( 規格)**

| ITEMS[項目]                                  | WR3006                                      | WR3266     | WR3296     | WR3329    | WR3362    | WR3386    |
|--|---|------------|------------|-----------|-----------|-----------|
| <b>Electrical Characteristics [ 電氣性能 ]</b> |   |            |            |           |           |           |
| Total resistance [ 全阻抗值 ]                  | 100Ω~1MΩ                                    |            |            |           |           |           |
| Total resistance tolerance [ 全阻抗值容許差 ]     | ±10% or ±20%                                |            |            |           |           |           |
| Ratings power(w) [ 額定功率 ]                  | 0.75W                                       | 0.25W      | 0.5W       | 0.5W      | 0.5W      | 0.5W      |
| Restings taper[阻抗變化特性]                     | (JIS)B                                      |            |            |           |           |           |
| Residual resistance [ 殘留阻值]                | R<=1KΩ:10Ω; R>1KΩ:1%RΩ [R=Total resistance] |            |            |           |           |           |
| Withstanding voltage [ 耐電壓]                | 630V AC                                     | 500V AC    | 500V AC    | 500V AC   | 640V AC   | 600V AC   |
| <b>Mechanical Characteristics [ 機械性能 ]</b> |   |            |            |           |           |           |
| Operation torque [ 回轉力矩 ]                  | 30~350gf . cm                               |            |            |           |           |           |
| Total rotational angle [回轉角度]              | 22±5 turns                                  | 12±2 turns | 28±5 turns | 280° ±10° | 250° ±10° | 300° ±10° |
| <b>Endurance Characteristics [ 耐久性能 ]</b>  |   |            |            |           |           |           |
| Rotational life [ 回轉壽命 ]                   | 200 cycles                                  |            |            |           |           |           |